



Equipped with AEM® Dryflow™ Filter
No Oil Required!

INSTALLATION INSTRUCTIONS

PART NUMBER: 21-9021

2004.5	CHEVROLET	Silverado 3500	V8-6.6L DSL LB7	C.A.R.B. E.O. # D-670
2004.5	CHEVROLET	Silverado 2500 HD	V8-6.6L DSL LB7	C.A.R.B. E.O. # D-670
2004.5	GMC	Sierra 3500	V8-6.6L DSL LB7	C.A.R.B. E.O. # D-670
2004.5	GMC	Sierra 2500 HD	V8-6.6L DSL LB7	C.A.R.B. E.O. # D-670
2001-2003	CHEVROLET	Silverado 3500	V8-6.6L DSL	C.A.R.B. E.O. # D-670
2001-2003	CHEVROLET	Silverado 2500 HD	V8-6.6L DSL	C.A.R.B. E.O. # D-670
2001-2003	GMC	Sierra 3500	V8-6.6L DSL	C.A.R.B. E.O. # D-670
2001-2003	GMC	Sierra 2500 HD	V8-6.6L DSL	C.A.R.B. E.O. # D-670

21-9021 will only fit on vehicles will LB7 engine types. Make note that only 2004.5 model year vehicles are equipped with the LB7 engine. 2004.5 model year vehicles with the LB7 engine type can be identified with the VIN. The 8th number of the VIN will be 1 on 2004.5 model year vehicles with the LB7 engine type.

*** NOTE: Legal in California only for racing vehicles which may never be used upon a highway**

PARTS LIST

Description	Qty.	Part Number
A Element Parts Kit 4.00x 9" DSL Oval Dry	1	21-2259DK
B Heat Shield	1	20-8021
C Inlet Pipe, Lower Duramax	1	2-80212
D Hose, Adapter 4.00/3.50x3" Blk.	1	5-435
E Inlet Pipe, Upper Duramax	1	2-80211
F Hose, Silicone 3.50x3" Blk.	1	5-350
G Insert, Diesel A/F Assy. 4"	1	5-2259
H Mount, Rubber 1" X 8mm	2	1228560
I 1/2" Bnd. Hose Clamp, 3.56"-4.50"	2	9464
J 1/2" Bnd. Hose Clamp, 3.15"-4.00"	3	9456
K Edge Trim, 18"	1	8-4018
L Rubber Edge Trim 20"	1	8-3020
M Wrench; Torx T20 T/R, L-Key	1	69801
N Bolt, Socket 8-32 X 5/16 SS	2	1-2023
O Adapter, Filter Minder Gauge	1	8-164
P Nut, M8 Hex Serrated	4	444.460.08
Q Washer, 8mm Soft Mount	4	559960

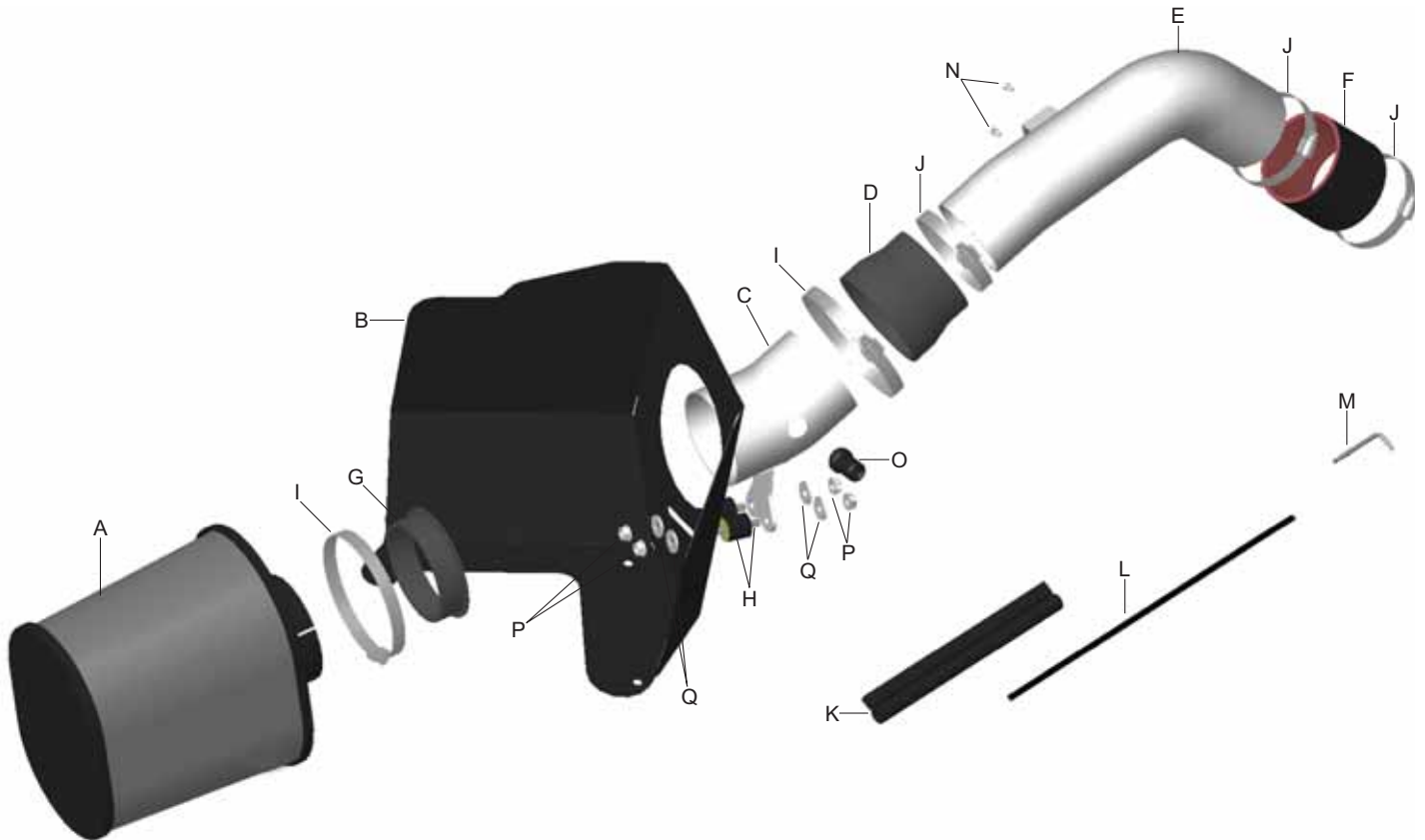

Read and understand these instructions **BEFORE** attempting to install this product. Failure to follow installation instructions and not using the provided hardware may damage the intake tube, throttle body and engine.

1. Preparing Vehicle

- a. Make sure vehicle is parked on level surface.
- b. Set parking brake.
- c. If engine has run in the past two hours, let it cool down.
- d. Disconnect negative battery terminal.
- e. Do not discard stock components after removal of the factory system.

2. Removal of stock system



a. Stock air box system.



b. Unplug the mass air flow (MAF) sensor wiring harness.



c. Lift up on the intake resonator to pop it off the mount. Loosen the hose clamps on both ends of the inlet tube.



d. Remove the inlet tube and resonator from the engine bay.



e. The air filter housing is held in place by two grommets on the mounting plate. Gently lift up on the air filter housing and remove it from the engine bay.



f. Remove the five bolts securing the air filter housing mounting plate to the vehicle chassis.



g. Remove the mounting plate from the truck.



h. Remove the factory air filter restriction gauge.



i. Using the supplied tamper-proof torx key, remove the two bolts securing the MAF sensor to the air filter housing. Carefully remove the MAF sensor from the housing.



j. Stock air box system removed.

3. Installation of AEM® intake system.

- a. When installing the intake system, do not completely tighten the hose clamps or mounting hardware until instructed to do so.



- b. Install the supplied rubber edge trim onto the edge of the hole in the heat shield. Trim to fit.



- c. Install the previously removed MAF sensor into the upper intake pipe using the two supplied 8-32 bolts.



- d. Install the heat shield in the engine bay aligning the holes with the mounting plate bolt locations. Secure it using three of the bolts removed in step 2f.



- e. Install the 3.5" coupler on the turbo inlet. Loosely secure the coupler with the supplied #56 hose clamps.



f. Install the reducing coupler onto the shallow bend side of the upper intake pipe. Slide the coupler all the way on the pipe with a #56 hose clamp but do not tighten the clamp.



g. Install the two supplied rubber mounts into the slot on the heat shield using two M8 nuts and washers. Secure the mounts with just enough slack for the mounts to slide in the slot.



h. Install the rubber adapter into the inlet intake pipe as shown.



i. Install the previously removed air filter restriction gauge into the rubber adapter in step 3h.

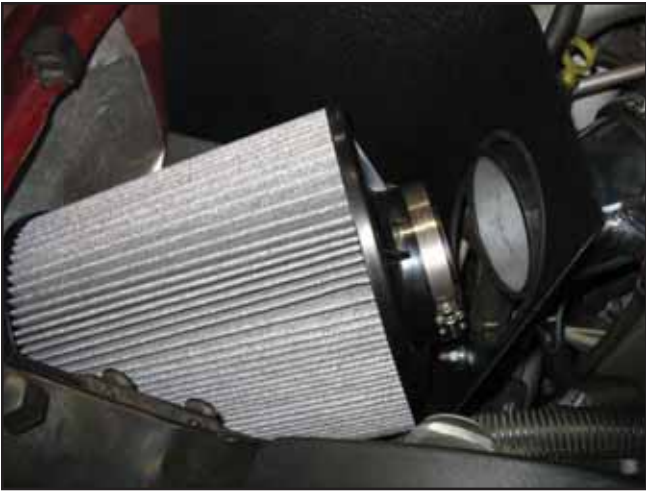

j. Slide the air filter into the engine bay with the filter neck facing the engine. This will help make the installation easier as the filter can not be installed with the lower pipe installed.



k. Install the lower pipe into the reducing roupler on the upper pipe. Use a #64 hose clamps to secure. Align the two holes in the mounting bracket with the two mounts on the heat shield.



l. Slide the lower pipe and reducing coupler down the upper pipe until mounting bracket face is flush with the rubber mounts. Install the remaining M8 washers and nuts to secure the lower pipe.



m. Install the air filter onto the end of the lower pipe, over the rubber filter adapter. Rotate the filter until it is not in contact with the vehicle and secure it using a #64 hose clamp.



n. Plug the MAF sensor into the wiring harness. Be sure that the harness is not in contact with any hot part of the engine.



Factory air box system installed



AEM® intake system installed

4. Reassemble Vehicle

- Position the inlet pipes for the best fitment. Be sure that the pipes or any other components do not contact any part of the vehicle. Tighten the rubber mount, all bolts, and hose clamps.
- Check for proper hood clearance. Re-adjust pipes if necessary and re-tighten them.
- Inspect the engine bay for any loose tools and check that all fasteners that were moved or removed are properly tightened.
- Reconnect negative battery terminals and start engine. Let the vehicle idle for 3 minutes. Perform a final inspection before driving the vehicle.

5. CARB Sticker Placement

- The C.A.R.B. exemption sticker, (attached), must be visible under the hood so that an emissions inspector can see it when the vehicle is required to be tested for emissions. California requires testing every two years, other states may vary.

6. Service and Maintenance

- It is recommended that you service your AEM® Dryflow™ filter every 20,000 miles for optimum performance. Use AEM Dryflow cleaning kit part # 21-110.
- Use aluminum polish to clean your polished AEM® intake tube.
- Use window cleaner to clean your powder coated AEM® intake tube. **(NOTE: DO NOT USE aluminum polish on powder coated AEM intake tubes).**

For technical inquiries
e-mail us at
sales@aemintakes.com
or
call us at
800.992.3000

AEM Air Intake System Warranty Policy

AEM® warrants that its intake systems will last for the life of your vehicle. AEM will not honor this warranty due to mechanical damage (i.e. improper installation or fitment), damage from misuse, accidents or flying debris. AEM will not warrant its powder coating if the finish has been cleaned with a hydrocarbon-based solvent. The powder coating should only be cleaned with a mild soap and water solution. Proof of purchase of both the vehicle and AEM intake system is required for redemption of a warranty claim.

This warranty is limited to the repair or replacement of the AEM part. In no event shall this warranty exceed the original purchase price of the AEM part nor shall AEM be responsible for special, incidental or consequential damages or cost incurred due to the failure of this product. Warranty claims to AEM must be transportation prepaid and accompanied with dated proof of purchase. This warranty applies only to the original purchaser of product and is nontransferable. Improper use or installation, use for racing, accident, abuse, unauthorized repairs or alterations voids this warranty. AEM disclaims any liability for consequential damages due to breach of any written or implied warranty on all products manufactured by AEM. Warranty returns will only be accepted by AEM when accompanied by a valid Return Merchandise Authorization (RMA) number. Credit for defective products will be issued pending inspection. Product must be received by AEM within 30 days of the date RMA is issued.

If you have a warranty issue, please call (800) 992-3000 and our customer service department will assist you. A proof of purchase is required for all AEM warranty claims.